

RECEIVED 22 SEP 2008
08/01607/OUT

SCANNED

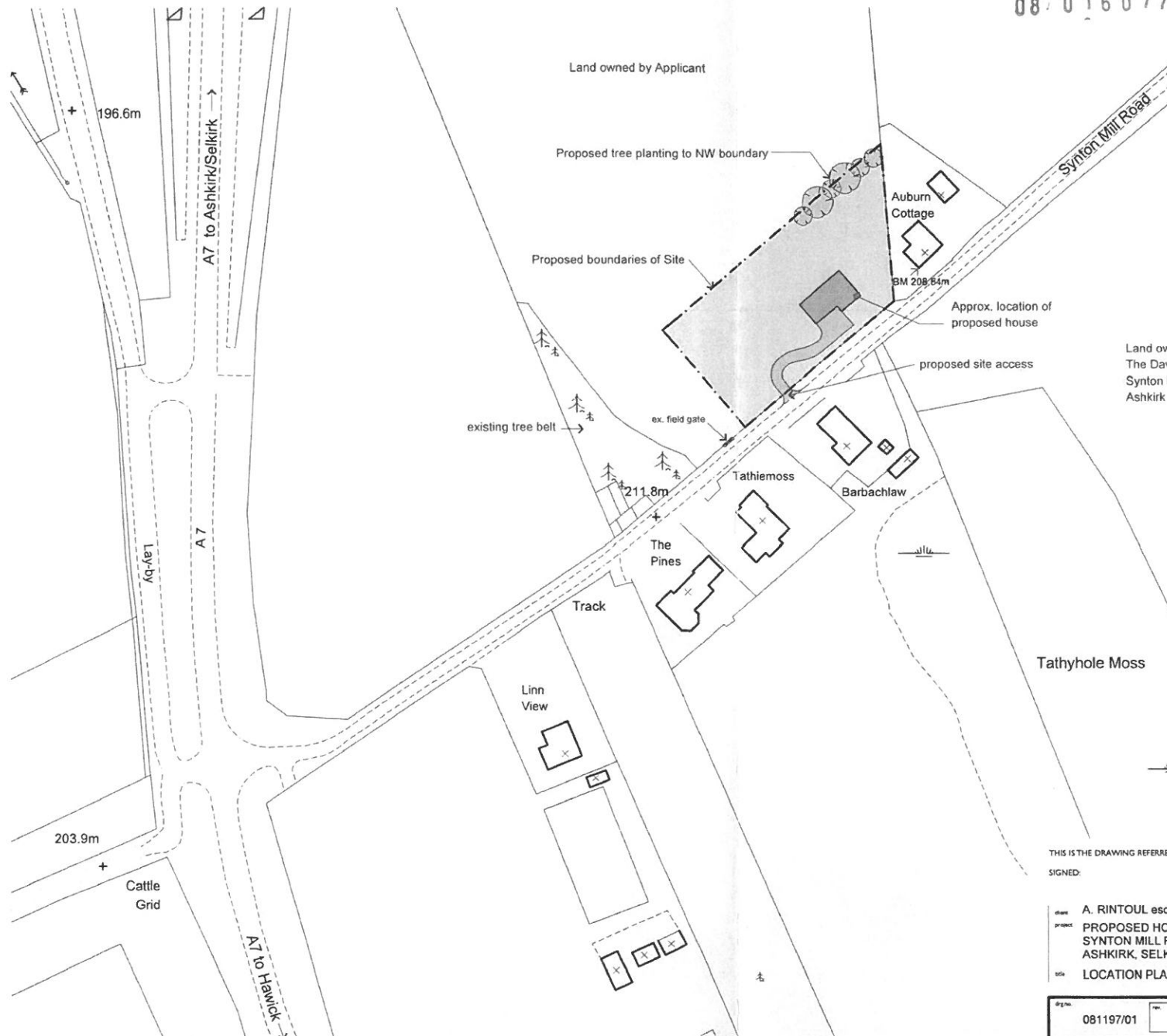

Note:
Proposed House location & size, and access
position are indicative only for Outline
Planning Consent purposes.
Final location & design of house to be subject
to a future Full Planning Consent application

Land owned by :
The Davies Partnership
Synton Mains
Ashkirk

Scottish Borders Council
Town & Country Planning (Scotland) Act
APPROVED
(Subject to conditions)
07 JAN 2009
Planning & Economic
Development Department

THIS IS THE DRAWING REFERRED TO IN THE APPLICATION DATED:
SIGNED:

drawn A. RINTOUL esq.
project PROPOSED HOUSE
SYNTON MILL ROAD
ASHKIRK, SELKIRK
title LOCATION PLAN

081197/01 1:1250
date sept.08



GORDON MELROSE MCIAT FIPD
BUILDING DESIGN
6 MARKET PLACE
SELKIRK
BORDERS
TD7 4BT
T.01750 725333
F.01750 725444
E.gordon@gmbuildingdesign.co.uk
www.gmbuildingdesign.co.uk